

Product Brochure For C273

4 Jaw Independent Lathe Chuck - K72-400/D1-8

Ø400mm

D1-8 Camlock Mount

On Sale

Ex GST

Inc GST

~~\$820.00~~

~~\$902.00~~

\$700.00

\$770.00



ORDER CODE:	C273
Chuck Size (mm):	Ø400
Camlock:	D1-8
Speed (rpm):	1000
D1 (mm):	139.7
D2 (mm):	171.4
D3 (mm):	125
H1 (mm):	95
h (mm):	14
Nett Weight (kg):	78



Description

Manufactured from High Strength semi steel and precision machined
 Jaws are case-hardened to minimise wear
 Operating screws are made from alloy steel and case-hardened
 Supplied with camlock pins, 1 set of jaws and wrench

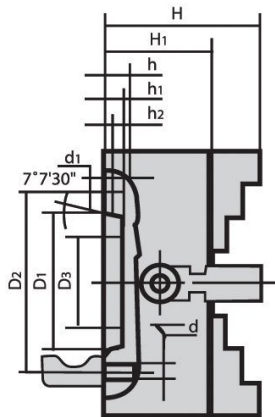

Product Brochure For C273

Specific Features



Camlock Mount



Included Accessories



Front View

Recommended Accessories

A358
Sky Hook Lifting Device



A358A
Chuck Hook



A358B
Choker Collar



A358C
Bolt Down Adaptor

