

Product Brochure For C275

## 4 Jaw Independent Lathe Chuck - K72-630/D1-11

Ø630mm

D1-11 Camlock Mount

Ex GST  
**\$2,090.00**

Inc GST  
**\$2,299.00**



ORDER CODE:	C275
Chuck Size (mm):	Ø630
Camlock:	D1-11
Speed (rpm):	600
D1 (mm):	196.8
D2 (mm):	235
D3 (mm):	180
H1 (mm):	118
h (mm):	16
Nett Weight (kg):	216

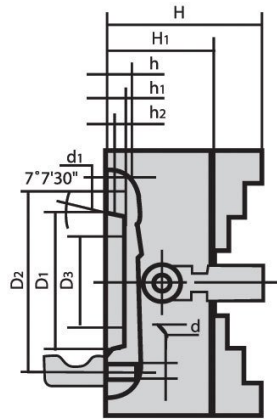

### Description

Manufactured from High Strength semi steel and precision machined  
 Jaws are case-hardened to minimise wear  
 Operating screws are made from alloy steel and case-hardened.  
 Supplied with camlock pins, 1 set of jaws and wrench.

Product Brochure For C275

**Specific Features**



Camlock Mount



Included Accessories

**Recommended Accessories**

A358  
Sky Hook Lifting Device



A358A  
Chuck Hook



A358B  
Choker Collar



A358C  
Bolt Down Adaptor

