

Product Brochure For M540

Face Mill Arbor - NT30 - FMB22-20



On Sale

Ex GST
~~\$60.00~~
\$50.00

Inc GST
~~\$66.00~~
\$55.00

| | |
|-----------------------|-----------------|
| ORDER CODE: | M540 |
| MODEL: | NT30 - FMB22-20 |
| Draw Bar (mm / inch): | 12mm |
| D (mm): | 22 |
| H (mm): | 18 |
| K (mm): | 5 |
| C (mm): | 44 |
| L (mm): | 20 |
| Nett Weight (kg): | 0.87 |

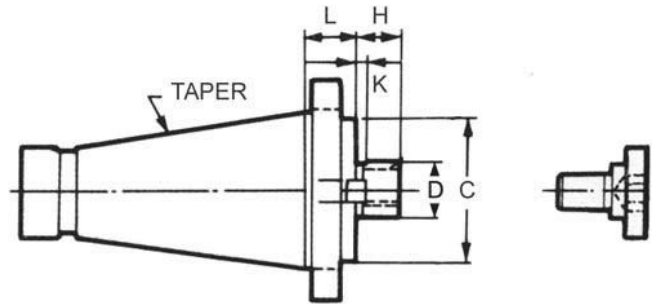

Features

- Material: SCM-21
- Hardness: HRC 50° - 55°
- Squareness of mounting surface: Less than 0.0002" (0.005mm)
- Deflection in shaft and taper: Less than 0.0002" (0.005mm)

Product Brochure For M540

Recommended Accessories

M510

Face Mill 90° - Positive Rake

M515

Face Mill 45° - Super High-Rake

M516

Face Mill 45° - Super High-Rake

