

Product Brochure For M542

Face Mill Arbor - NT30 - FMB27-20



**On Sale**

Ex GST	Inc GST
<del>\$60.00</del>	<del>\$66.00</del>
<b>\$50.00</b>	<b>\$55.00</b>

ORDER CODE:	M542
MODEL:	NT30 - FMB27-20
Draw Bar (mm / inch):	12mm
D (mm):	27
H (mm):	20
K (mm):	7
C (mm):	54
L (mm):	20
Nett Weight (kg):	1.05

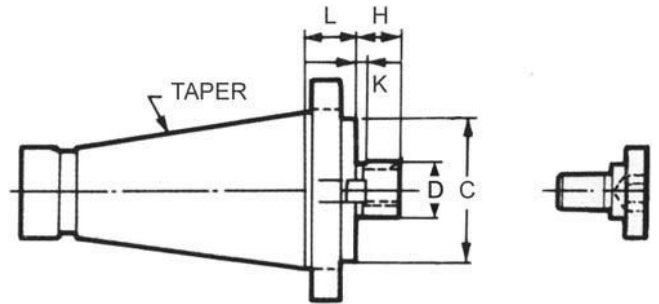

**Features**

- Material: SCM-21
- Hardness: HRC 50° - 55°
- Squareness of mounting surface: Less than 0.0002" (0.005mm)
- Deflection in shaft and taper: Less than 0.0002" (0.005mm)

Product Brochure For M542

---

**Recommended Accessories**

M511

Face Mill 90° - Positive Rake

M512

Face Mill 90° - Positive Rake

M517

Face Mill 45° - Super High-Rake

