

Product Brochure For M555

Face Mill Arbor - NT40 - FMB40-20

**On Sale**

Ex GST	Inc GST
<del>\$110.00</del>	<del>\$121.00</del>
<b>\$90.00</b>	<b>\$99.00</b>



ORDER CODE:	M555
MODEL:	NT40 - FMB40-20
Draw Bar (mm / inch):	16mm
D (mm):	40
H (mm):	23
K (mm):	8
C (mm):	85
L (mm):	20
Nett Weight (kg):	2.70

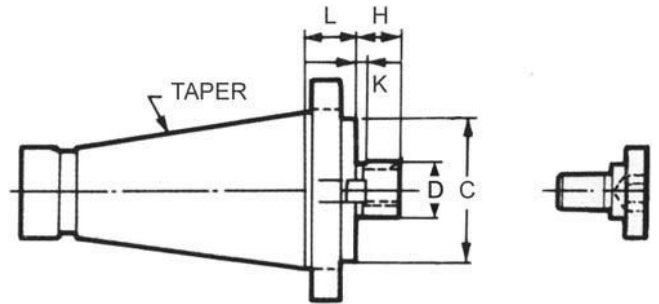

**Features**

- Material: SCM-21
- Hardness: HRC 50° - 55°
- Squareness of mounting surface: Less than 0.0002" (0.005mm)
- Deflection in shaft and taper: Less than 0.0002" (0.005mm)

Product Brochure For M555

---

**Recommended Accessories**

M503

Face Mill 90° - Positive Rake

M504

Face Mill 90° - Positive Rake

