

Product Brochure For S989S

## 35° Top Punch Pressbrake Tooling - Segmented - TP35-116.800S

116mm High x 800mm Long, Divided in Segments - 10, 15, 20, 40,  
 50, 100, 200, 365mm Amada & European Pressbrakes

**On Sale - Back In Stock Soon**

Ex GST	Inc GST
<del>\$630.00</del>	<del>\$693.00</del>
<b>\$580.00</b>	<b>\$638.00</b>

Order Code:	S989S
Model:	TP35-116.800S
Type:	35° Top Punch
Size (mm):	116 x 800 In Segments Of & 10,20,40,50,100,200,365



### Description

Precision Pressbrake Punch made from chromium-molybdenum high strength steel and heat treated for long term durability.

- Nose Angle - 35 Degrees
- Nose Radius - 1.5mm
- Total Height - 116mm
- Shoulder height - 86mm
- Max. Tonnage - 700kN/m
- Length - 800mm divided into the following segments: 10, 15, 20, 40, 50, 100, 200, 365mm

Suits MetalMaster, Amada & European Pressbrakes

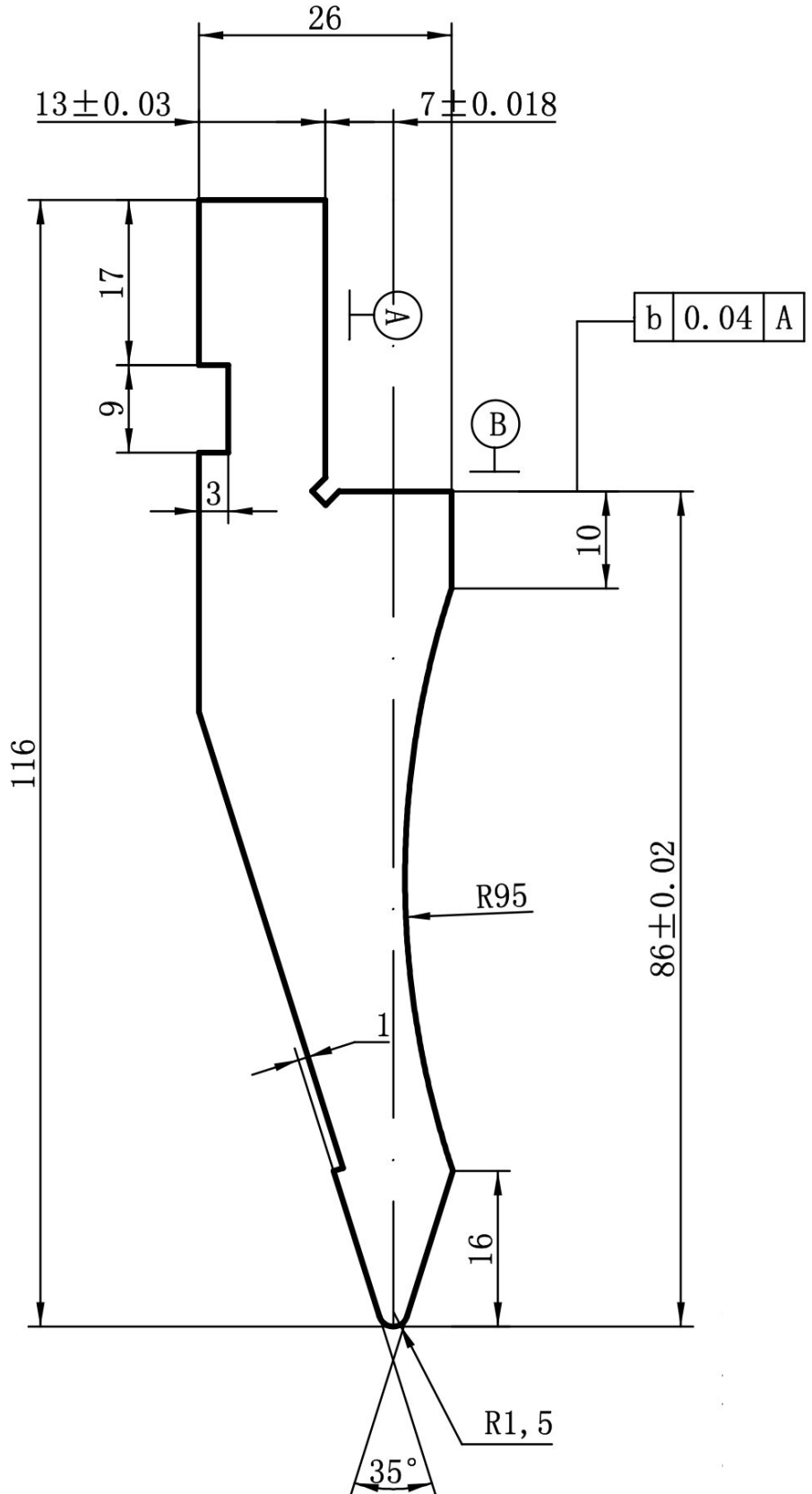

Product Brochure For S989S

---

**Specific Features**



Profile



Side View